



CITY OF SOUTH TUCSON BOUNDARY MAP

N

W

E

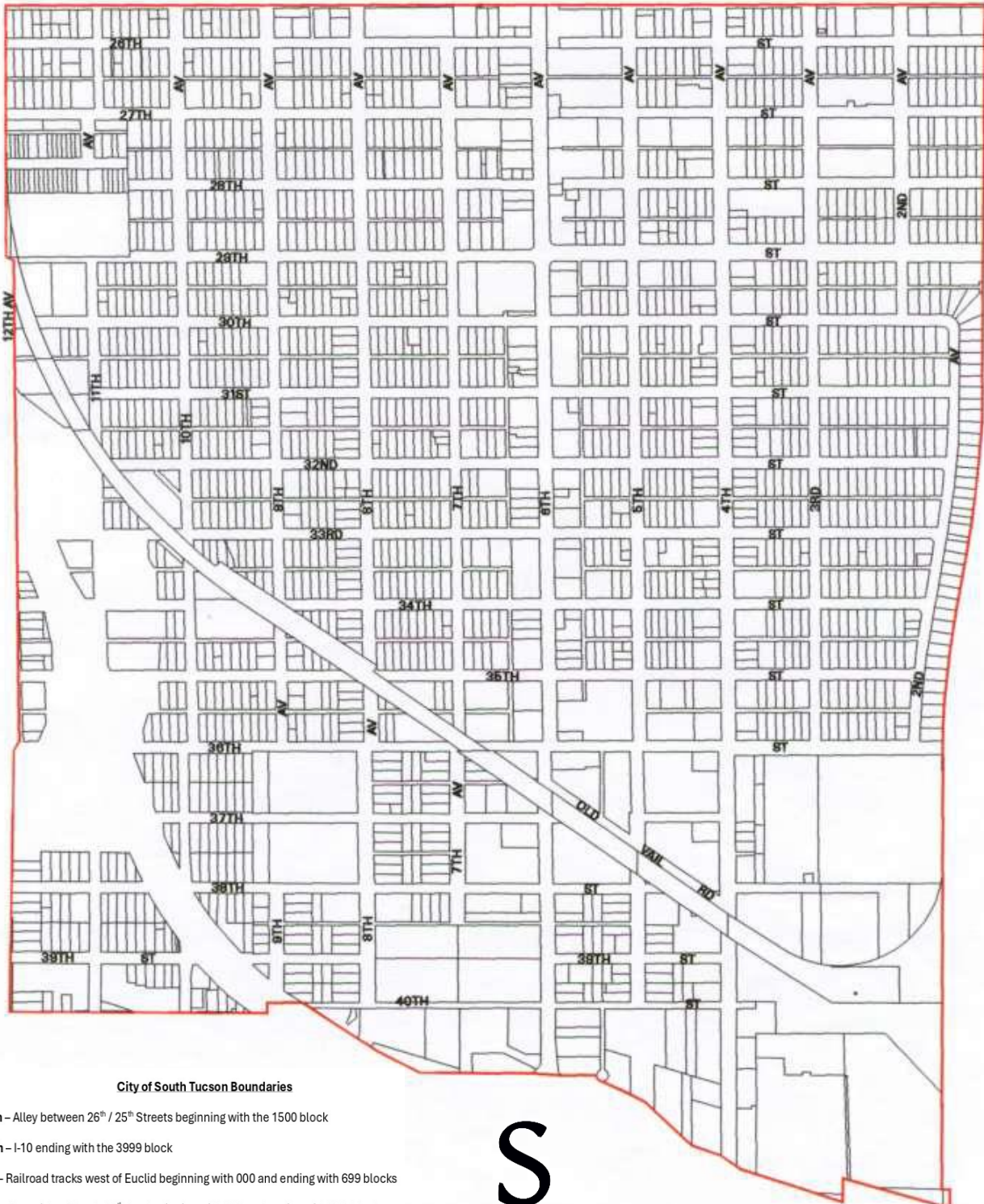

City of South Tucson Boundaries

North – Alley between 26th / 25th Streets beginning with the 1500 block

South – I-10 ending with the 3999 block

East – Railroad tracks west of Euclid beginning with 000 and ending with 699 blocks

West – East side of South 12th Ave beginning with 000 and ending with 599 blocks